

User Manual

Solar Street Light

210 mm

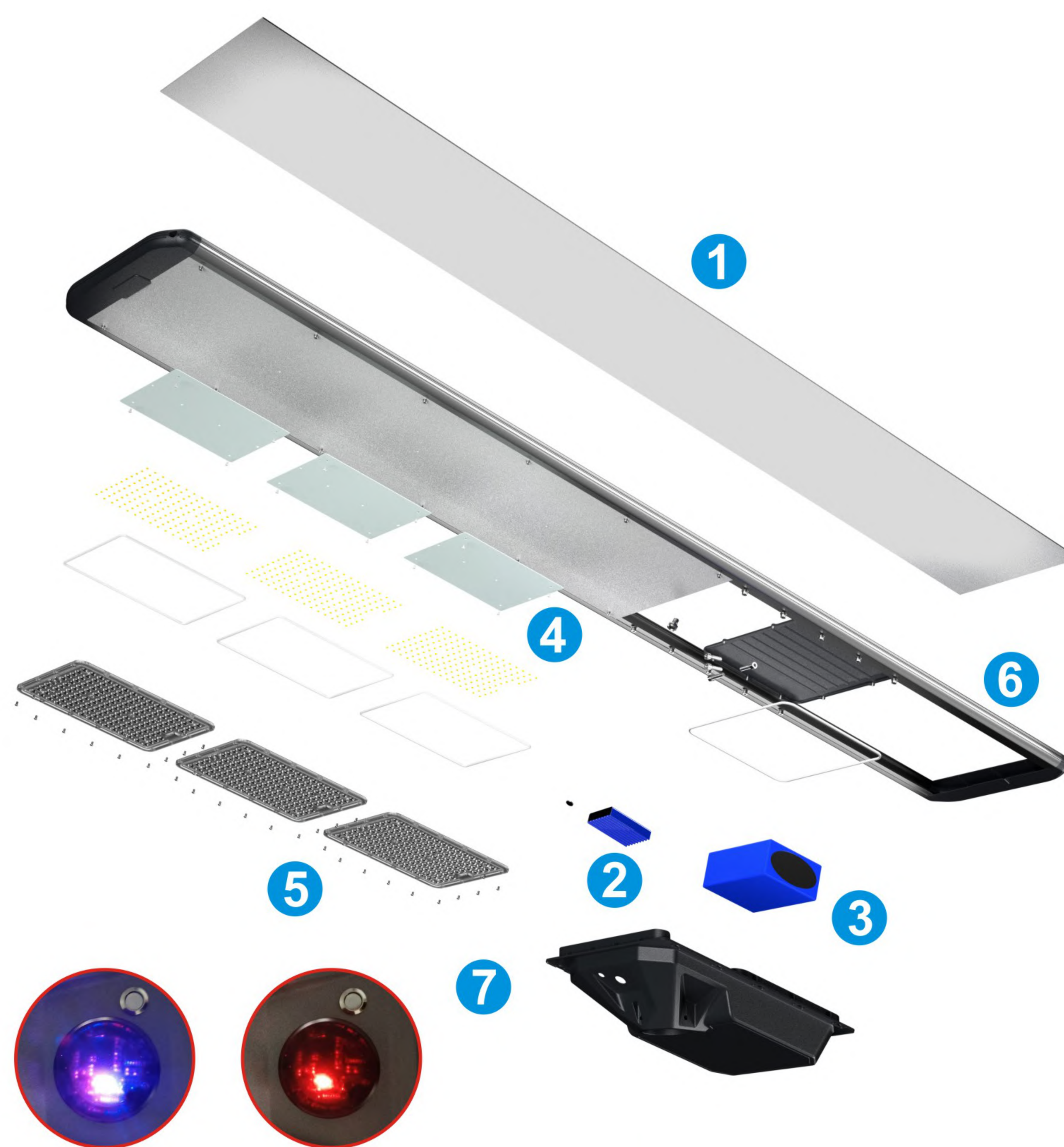

- 1 Mono Solar Panel
- 2 Control Module
- 3 LifePo4 Battery
- 4 LED Plate
- 5 Optical Len
- 6 Die-cast Aluminum Bracket
- 7 Red Point Always On Light: Battery have power
 Red Point Flashing Slowly: Battery will power down soon
 Red Point Flashing quickly: Controller are in short circuit
 Green Point Flashing Slowly: The light in on charging
 Red Point Flashing quickly: Almost Full Charge
 Blue Point Always On Light: The led chip is 100% wattage on light
 Blue Point Flashing Slowly: The led chip is 90%-20% wattage on light
 Blue Point Flashing quickly: LED chip are in short circuit

How is the light working?

